

Devon County Council (Dartmoor National Park) (Off Street Parking Places) Order

Devon County Council, in consultation with Dartmoor National Park Authority make the following order in exercise of powers under sections 32 and 35 of the Road Traffic Regulation Act 1984 ("1984 Act"), under the Traffic Management Act 2004 ("2004 Act") and all other enabling powers

PART A - INTERPRETATION

1 In this order except where the context otherwise requires the following expressions have these meanings assigned to them

appropriate remittance means

- a) in relation to pay and display is the rate in column 8 of the table in part 1 of schedule 1
- b) in relation to parking permits is the sum specified in column 4 of the table in schedule 2 for the period that relates to a permit which is valid in one or more of the designated parking places referred to in the schedules

authorised vendors means a business or service approved by the Authority

Authority means Dartmoor National Park Authority

civil enforcement officer has the meaning given in section 76 of the 2004 Act

coaches has the same meaning as buses in regulation 22(2) of The Traffic Signs Regulations and General Directions 2016 and **coach** shall be construed accordingly

Council means Devon County Council

delivering and **collecting** in relation to any goods include checking the goods for the purpose of their delivery or collection

disabled person and **disabled person's badge** have the same meaning as in the Disabled Persons' (Badges for Motor Vehicles) (England) Regulations 2000

disabled persons vehicle means a vehicle lawfully displaying a disabled person's badge and which is a vehicle that immediately before or after any period of waiting allowed by virtue of a provision of a kind required by the Local Authorities' Traffic orders (Exemptions for Disabled Persons) (England) Regulations 2000 to be included in an order under the 1984 Act has been or is to be driven by a disabled person or has been or is to be used for carrying disabled persons as passengers

driver in relation to a vehicle waiting in a parking place means the person driving the vehicle at the time it was left in the parking place

enforcement authority means the authority specified in column 2 of the table in Part 1 of Schedule 1 or an agent working on behalf of that authority

goods includes postal packets of any description and the collection and delivery in relation to any goods including the checking of the goods for the purpose of delivery and collection

issuing authority means the enforcement authority, the Authority, the Council or an agent acting on behalf of the Authority or the Council

minibuses has the same meaning as defined in The Road Vehicles (Construction and Use) Regulations 1986 and **minibus** shall be construed accordingly

motorcycle means a mechanically propelled vehicle (not being an invalid carriage) with fewer than 4 wheels of which the weight un-laden does not exceed 410 kilograms

parking area means an area marked for the leaving of specified types of vehicles within a parking place

parking place means the area bounded by a red line on the relevant plan in Part 3 of Schedule 1

parking permit refers to a permit issued by the issuing authority under part D

parking space means a space individually marked for the leaving of a vehicle within a parking place

penalty charge has the same meaning as in regulation 2(1) of the Civil Enforcement of Parking Contraventions (England) General Regulations 2007

permit holder means a person who has been issued with a parking permit

relevant position means

- a) In the case of a disabled person's badge the position described in regulation 4 of the Local Authorities' Traffic orders (Exemptions for Disabled Persons) (England) Regulations 2000
- b) In the case of a parking disc a vehicle displays the disc in the relevant position if
 - i) in the case of a vehicle fitted with a dashboard or a fascia panel the disc is exhibited so that the quarter-hour period during which the period of waiting began is legible from outside the vehicle throughout the permitted period of parking; or
 - ii) in the case of a vehicle not so fitted the disc is exhibited in a conspicuous position on the vehicle so that the quarter-hour period during which the period of waiting began is legible from outside the vehicle throughout the permitted period of parking
- c) In the case of pay and display the ticket referred to in part C, it shall be exhibited on the vehicle dashboard or fascia so that the time shown on the front of the ticket is clearly visible throughout the permitted period of parking
- d) In the case of any other badge or permit
 - i) in the case of a vehicle fitted with a front windscreen, the badge or permit is exhibited on the dashboard or fascia facing forwards on the near side of and immediately behind the windscreen or affixed to the windscreen so that the necessary details are clearly visible from outside of the vehicle throughout the permitted period of parking
 - ii) in the case of a vehicle not fitted with a front windscreen, the badge or permit is exhibited in a conspicuous position on the front or near side of the vehicle throughout the permitted period of parking

taxed means the vehicle has up-to-date vehicle tax as recorded by the DVLA

valid ticket means a ticket obtained under provisions of this order for parking in a parking place/ parking space/ parking area

- 2
 - a) Unless stated any reference to an article, part or schedule refers to the corresponding article, part or schedule in this order and except where the context otherwise requires any reference to a numbered or lettered paragraph or sub-paragraph is a reference to the paragraph or sub-paragraph bearing that number or letter in the article or schedule or (in the case of a sub-paragraph) paragraph in which the reference occurs
 - b) The restrictions imposed by this order shall be in addition to and not in derogation of any restriction or requirement imposed by any regulations made under or having effect as if made under the 1984 Act or by or under any other enactment
 - c) Any reference in this order to any enactment shall be construed as a reference to that enactment as amended by any subsequent enactment
 - d) The Interpretation Act 1978 shall apply for the interpretation of this order as it applies for the interpretation of an Act of Parliament

PART B - PARKING PLACES

- 3 The limits of each parking space, where defined, shall be indicated by markings appropriate to the position in which a vehicle may park
- 4 The limits of each parking area, where defined, shall be indicated by markings appropriate to the area in which vehicles of a specified type may park
- 5 Only vehicles authorised to do so by Part F are permitted to park without displaying a valid ticket or permit, where one is required. Otherwise, a penalty charge shall be payable
- 6 Provided always that the provisions of article 7 apply to any parking place or any part thereof, and in the event of any contravention of or non-compliance with a provision of article 7 the person responsible shall be liable to a penalty charge

suspension of parking places

- 7** The Authority or the Council may subject to such conditions or exemptions as they consider necessary suspend the use of the parking place or any part thereof
- a) if it is satisfied that the use of the parking place should be restricted or prohibited by reason that works are being or are proposed to be executed on or near the parking place or due to the likelihood of danger to the public or of serious damage to the parking place
 - b) for facilitating the movement of traffic or promoting its safety
 - c) any other reasons deemed appropriate by the Authority or the Council

miscellaneous conditions

- 8** A driver of a vehicle shall not use a parking place
- a) so as to be a nuisance
 - b) when such parking place or part thereof if it has been suspended in accordance with the provisions of article 7
 - c) unless the vehicle has been taxed and the driver is insured to use the vehicle
 - d) for sleeping, camping, fires or cooking
- 9** No person shall
- a) sell, offer or exhibit for sale or hire any vehicle while it is in a parking place
 - b) use a vehicle while it is in a parking place in connection with the sale of any article to persons in or near the parking place or in connection with the selling or offering for hire of their skills in handicraft or services in any capacity
- provided** always that this article shall not be deemed to prohibit authorised vendors
- 10** No person shall carry out upon any vehicle while it is in a parking place any work of construction, cleaning, maintenance or repair except such as may be expedient to enable the vehicle to be moved from the parking place

moving and removing vehicles

- 11** When a vehicle is left in the parking place in contravention of or non-compliance with any of the provisions of this order a person authorised by and on behalf of the enforcement authority may remove the vehicle or arrange for it to be removed from the parking place or if appropriate move the vehicle so that its position complies with the provisions of this order
- 12** In case of an emergency the police or a person authorised by the enforcement authority may alter the position of a vehicle in the parking place or remove the vehicle or arrange for it to be removed from the parking place to a place they think fit
- 13** Any person altering the position of a vehicle in or removing a vehicle from the parking place may take such measures in relation to the vehicle as they think necessary to enable them to remove it or alter its position
- 14** When the police or a person authorised by the enforcement authority removes or makes arrangements for the removal of a vehicle from the parking place
- a) they shall make arrangements as are reasonably necessary for the safe custody of the vehicle
 - b) the owner/driver of the vehicle shall be required to contact the police or the enforcement authority to determine how to recover the vehicle

PART C - DESIGNATION AND USE OF PARKING PLACES

manner of standing in parking places

- 15** The driver of a motor vehicle using a parking place shall stop the engine as soon as the vehicle is in position and shall not start the engine except when about to change position or to depart from the parking place
- 16** Where the limits of each parking space are defined, either by use of lines, surface materials or other physical means, a vehicle may only be parked wholly within a parking space defined. Where the limits of a parking area is defined, either by use of lines, surface materials or other physical means, vehicles may only be parked wholly within the parking area defined. Where the limits are not defined, vehicles must not be parked in areas that are defined as no parking areas

pay & display

- 17** Save as provided in part F a vehicle is only permitted to wait in a parking place if
- a) it complies with the restrictions specified in schedule 1 and
 - b) the appropriate remittance has been paid either by the purchase of a ticket, which is then displayed in the relevant position, or where available, by payment using a mobile phone or other device
- 18** Where any vehicle exceeds the size limitations of a defined parking space, the appropriate remittance must be paid for all parking spaces the vehicle encroaches
- 19** Pay and display ticket machines will be at locations signed within the parking place. In the event of a ticket machine being inoperable and an alternative ticket machine is available nearby the driver must obtain a ticket and display the ticket in a relevant position. If no alternative ticket machine is available for use, and the driver is unable to make a payment by means of a mobile phone or device; the driver must contact the enforcement authority as soon as practical. The vehicle must not be parked for any longer than the maximum period of parking permitted for that parking place and must not return to the parking place within 1 hour
- 20** The initial charge is payable on the leaving of a vehicle in a pay and display parking place and is the appropriate remittance specified in corresponding tariff to purchase a ticket from a pay and display ticket machine or a payment made by means of a mobile phone or device, if that service is available, to cover the anticipated length of stay subject to the maximum stay permitted at that parking place
- 21** Upon payment of the initial charge for the vehicle any valid ticket(s) must be displayed in a relevant position
- 22** Where an initial charge has been made on the leaving of a vehicle in a parking place referred to in article 21 by obtaining a ticket from the relevant pay and display ticket machine or where available, a payment made by means of a mobile phone or device that vehicle is not
- a) to remain in the parking place beyond the expiry time of the displayed ticket or mobile phone/device paid period; or
 - b) to have additional time purchased for it if the total amount of time it remains in the parking place exceeds the maximum stay permitted for that parking place; or
 - c) permitted to return to that parking place until 1 hour has elapsed since the end of the last period of waiting in that parking place

disabled badge holder only parking spaces

- 23** Save as provided in part F no person shall cause or permit a vehicle to park in a parking space marked for a disabled persons vehicle unless the vehicle displays a valid Disabled Person's Badge in the Relevant Position, otherwise a penalty charge is payable

parking spaces/areas for coaches

- 24** Save as provided in part F no person shall cause or permit a vehicle to park in a parking space/area marked for a coach unless the vehicle is a coach, bus or minibus, otherwise a penalty charge is payable

parking spaces/areas for permit holders

- 25** Save as provided in part F no person shall cause or permit a vehicle to park in a parking space/area marked for permit holders, otherwise a penalty charge is payable

miscellaneous parking spaces

- 26** Save as provided in part F, where a parking space is marked for a specific type of vehicle, no person shall cause or permit a vehicle to park in that parking space unless that vehicle is of the type specified, otherwise a penalty charge is payable

PART D - PROVISIONS RELATING TO PARKING PERMITS

- 27** Schedule 2 contains the list of the permit types and related charges
- 28** The issuing authority may require a permit applicant to produce evidence in respect of the application as they reasonably require to verify any particulars or information given
- 29** The issuing authority can terminate all rights granted by the permit if at any time there is any contravention of any of the provisions or terms and conditions and the permit holder will not be entitled to any refund in respect of the amount paid for the permit
- 30** A parking permit shall include the following particulars that must be visible when displayed in the relevant position
- a) the registration of the vehicle (or a variation agreed by the issuing authority)
 - b) the expiry date of the permit, if applicable
 - c) an authentication that it was issued by the issuing authority
- 31** All permit types remain the property of the issuing authority
- 32** All permits must be displayed in the relevant position within the vehicle throughout the permitted period of parking

vehicles for which permits can be used

- 33** Only those vehicles specified in column 4 of the table in Part 1 of Schedule 1 may use a permit issued under the provisions in this part of the order within the parking place, unless there are specific provisions in place to the contrary and information regarding this will be provided on the application form or terms and conditions for the permit

eligibility to apply for parking permits

- 34** A person as identified in column 3 of the table in Schedule 2, may apply to the issuing authority for the issue of a parking permit to authorise a vehicle to park in a parking place for which the permit applies. The application shall include the particulars and information required by the issuing authority and shall be accompanied by the appropriate remittance
- 35** On receipt of an application made under the provisions of this part of the order and of the appropriate remittance the issuing authority, upon being satisfied that the applicant is eligible, may issue to the applicant a parking permit or permits for the leaving of the vehicle or vehicles to which the parking permit relates by the owner of that vehicle or by any person using the vehicle with the consent of the owner other than a person who the vehicle has been let for hire or reward, in any parking place to which the parking permit relates

lost damaged destroyed or replacement permits

- 36** If a permit is lost, damaged, destroyed or requires renewing due to a change of vehicle the permit holder may apply to the issuing authority for the issue of a replacement and the issuing authority upon being satisfied as to the loss, damage or destruction shall upon payment of a fee determined in Schedule 2 issue a replacement permit and upon such issue the permit which it replaces shall become invalid
- 37** If a permit requires replacement due to a change of vehicle the permit holder may apply to the issuing authority for the issue of a replacement and the issuing authority, upon being satisfied as to the legitimacy of the change of vehicle, and on return of the original permit, shall issue a replacement permit without charge
- 38** If a permit becomes mutilated or defaced or the figures or particulars become illegible or the colour becomes altered by fading or otherwise the permit holder shall surrender it to the issuing authority and may then apply for the issue of a replacement permit
- 39** If a permit is lost or destroyed and the permit holder has applied to the issuing authority for the issue of a replacement the original must be surrendered if it is subsequently found or retrieved
- 40** The provisions of this order apply to the replacement permit and application for the permit as if it were a permit or as the case may be an application for a permit transfer and surrender of permits
- 41** The issuing authority may at its discretion levy an administration charge for the issue of a replacement permit whether or not a charge was made for the permit it replaces
- 42** A parking permit shall not be transferred to any person or business but may be surrendered at any time to the issuing authority and shall be surrendered in the event of
- a) the permit holder ceasing to be eligible for a permit by virtue of no longer meeting the terms and conditions specified in schedule 2 of the relevant appendix; or
 - b) the permit holder ceasing to be the owner of the vehicle to which a permit has been issued; or
 - c) a replacement permit issued under the provisions of articles 36 to 38; or
 - d) the expiry of the period for which the permit was issued
- 43** A permit holder may surrender a permit to the issuing authority at any time and shall surrender a permit on the occurrence of any of the events set out in article 42
- 44** The issuing authority may by notice in writing served on the permit holder withdraw a permit if it appears that any of the events set out in article 42 has occurred and the permit holder shall surrender the permit within forty-eight hours of the receipt of the said notice
- 45** It shall be an offence to alter the said parking permit in any manner and any person so doing may have the parking permit withdrawn

PART F - EXEMPTIONS

general exemptions from prohibitions & restrictions

- 46** Nothing in this order shall apply to anything done with the permission or at the direction of a police officer, civil enforcement officer or an officer authorised by the enforcement authority
- 47** No provision of this order shall apply to a vehicle being used for ambulance, coastguard, fire, police or search and rescue purposes in relation to an emergency or whilst in pursuit of duties

or police purposes if the observance of that provision would be likely to hinder the use of that vehicle for the purpose for which it is being used on that occasion

- 48** No provision of this order shall apply to
- a) Dartmoor National Park Authority liveried vehicles
- 49** Nothing within article 17 shall apply to
- a) vehicles displaying a staff permit or
 - b) vehicles displaying a temporary permit
- 50** Nothing in this order shall make it unlawful to cause or permit a vehicle to wait in a parking place for so long as may be necessary to enable
- a) a person to board or alight the vehicle or to load/unload luggage to/from the vehicle
 - b) the vehicle to be used for the purpose of delivering or collecting postal packets as defined in section 87 of the Post Office Act 1953
 - c) the vehicle to be used in connection with the removal of furniture from one building to another
 - d) the vehicle to be used for the purpose authorised by and described on a permit issued by the enforcement authority or the Council provided such permit is clearly displayed in the relevant position

PART G - COMMENCEMENT & CITATION

- 51** This order comes into operation _____ and may be cited as “Devon County Council (Dartmoor National Park) (Off Street Parking Places) Order _____”

SCHEDULE 1
Parking Places

PART 1

Location of Parking Place	Enforcement authority	Type of Parking Place ¹	Class of vehicle ²	Days and Hours of operation	Days and Hours when charges will be made	Maximum period for which vehicles may wait	Scale of Charges	
<i>Column 1</i>	<i>Column 2</i>	<i>Column 3</i>	<i>Column 4</i>	<i>Column 5</i>	<i>Column 6</i>	<i>Column 7</i>	<i>Column 8</i>	
Brentor Car Park (Plan 1A)	Devon County Council	a,b	A, A1, B, B1, D1, L, P	At all times	Monday to Sunday 10am to 6pm	All day	<i>Motorcycles</i>	FREE
							<i>Disabled Persons Vehicle</i> All day	£2.00
							<i>Minibuses</i> All day	£5.00
							<i>All Other Vehicles</i> Up to 3 hours Over 3 hours	£2.00 £3.00
Haytor Coach Park (Plan 1B)	Devon County Council	a,b	D, D1	At all times	Monday to Sunday 10am to 6pm	All day	<i>Minibuses & Coaches</i> All day	£5.00
Haytor Lower Car Park (Plan 1C)	Devon County Council	a,b	A, A1, B, B1, D1, L, P	At all times	Monday to Sunday 10am to 6pm	All day	<i>Motorcycles</i>	FREE
							<i>Disabled Persons Vehicle</i> All day	£2.00
							<i>Minibuses</i> All day	£5.00
							<i>All Other Vehicles</i> Up to 3 hours Over 3 hours	£2.00 £3.00

¹ See Note 1 in Part 2

² See Note 2 in Part 2

Location of Parking Place	Enforcement authority	Type of Parking Place ¹	Class of vehicle ²	Days and Hours of operation	Days and Hours when charges will be made	Maximum period for which vehicles may wait	Scale of Charges	
<i>Column 1</i>	<i>Column 2</i>	<i>Column 3</i>	<i>Column 4</i>	<i>Column 5</i>	<i>Column 6</i>	<i>Column 7</i>	<i>Column 8</i>	
Haytor Middle Car Park (Plan 1D)	Devon County Council	a,b	A, A1, B, B1, D1, L, P	At all times	Monday to Sunday 10am to 6pm	All day	<i>Motorcycles</i>	FREE
							<i>Disabled Persons Vehicle</i> All day	£2.00
							<i>Minibuses</i> All day	£5.00
							<i>All Other Vehicles</i> Up to 3 hours Over 3 hours	£2.00 £3.00
Haytor Upper Car Park (Plan 1E)	Devon County Council	a,b	A, A1, B, B1, D, D1, L, P	At all times	Monday to Sunday 10am to 6pm	All day	<i>Motorcycles</i>	FREE
							<i>Disabled Persons Vehicle</i> All day	£2.00
							<i>Minibuses & Coaches</i> All day	£5.00
							<i>All Other Vehicles</i> Up to 3 hours Over 3 hours	£2.00 £3.00
Lydford Car Park (Plan 1F)	Devon County Council	a,b	A, A1, B, B1, D, D1, L, P	At all times	Monday to Sunday 10am to 6pm	All day	<i>Motorcycles</i>	FREE
							<i>Disabled Persons Vehicle</i> All day	£2.00
							<i>Minibuses & Coaches</i> All day	£5.00
							<i>All Other Vehicles</i> Up to 3 hours Over 3 hours	£2.00 £3.00

Location of Parking Place	Enforcement authority	Type of Parking Place ¹	Class of vehicle ²	Days and Hours of operation	Days and Hours when charges will be made	Maximum period for which vehicles may wait	Scale of Charges	
<i>Column 1</i>	<i>Column 2</i>	<i>Column 3</i>	<i>Column 4</i>	<i>Column 5</i>	<i>Column 6</i>	<i>Column 7</i>	<i>Column 8</i>	
Meldon Reservoir Car Park (Plan 1G)	Devon County Council	a,b	A, A1, B, B1, D, D1, L, P	At all times	Monday to Sunday 10am to 6pm	All day	Motorcycles	FREE
							Disabled Persons Vehicle All day	£2.00
							Minibuses & Coaches All day	£5.00
							All Other Vehicles Up to 3 hours Over 3 hours	£2.00 £3.00
Postbridge Car Park (Plan 1H)	Devon County Council	a,b	A, A1, B, B1, D1, L, P D in marked coach areas only	At all times	Monday to Sunday 10am to 6pm	All day	Motorcycles	FREE
							Disabled Persons Vehicle All day	£2.00
							Minibuses & Coaches All day	£5.00
							All Other Vehicles Up to 3 hours Over 3 hours	£2.00 £3.00
Princetown Car Park (Plan 1I)	Devon County Council	a,b	A, A1, B, B1, D1, L, P D in marked coach areas only	At all times	Monday to Sunday 10am to 6pm	All day	Motorcycles	FREE
							Disabled Persons Vehicle All day	£2.00
							Minibuses & Coaches All day	£5.00
							All Other Vehicles Up to 3 hours Over 3 hours	£2.00 £3.00

PART 2

Note 1 - Type of Parking Place

This means the type of parking available at the parking place as specified by the letters in Column 3 of the table in Part 1

- a** means 'pay and display'. Each period of parking is paid for in advance in accordance with article 17 b)
- b** means 'permit parking'. Parking is free to permit holders displaying a valid permit in the relevant position

Note 2 - Class of Vehicle

This describes the class of vehicle as determined by the DVLA that are permitted to park in each parking place specified by the letters in Column 4 of the table in Part 1

- A and A1** means any motorcycle (with or without a side car)
- B** means any motor vehicle and light goods vehicle with up to 8 seats up to 3,500kg Maximum Authorised Mass (MAM)
- B1** means any motor vehicle weighing not more than 400 kg unladen (550 kg laden) (other than an invalid carriage)
- C1** means Goods Vehicle with MAM between 3,500 and 7,500 kg and pulling trailer, as long as the total weight of both vehicles is not more than 8,250 kg.
- D** means any bus/coach with more than eight passenger seats, with a trailer up to 750 kg
- D1** means Passenger carrying vehicle with between 9 and 17 seats (driving for hire or reward)
- L** means electrically propelled vehicle (other than an invalid carriage)
- P** means Moped with an engine size of up to 50cc and a maximum speed of up to 50km/h

PART 3

Index of Plans

Plan 1A	Brentor Car Park
Plan 1B	Haytor Coach Park
Plan 1C	Haytor Lower Car Park
Plan 1D	Haytor Middle Car Park
Plan 1E	Haytor Upper Car Park
Plan 1F	Lydford Car Park
Plan 1G	Meldon Reservoir Car Park
Plan 1H	Postbridge Car Park
Plan 1I	Princetown Car Park

Dartmoor National Park Authority

Brentor Car Park

Scale 1:1,250

Map created by awatson on 30/5/2022





Dartmoor National Park Authority

Haytor Lower Car Park

Scale 1:1,250

Map created by awatson on 18/2/2022

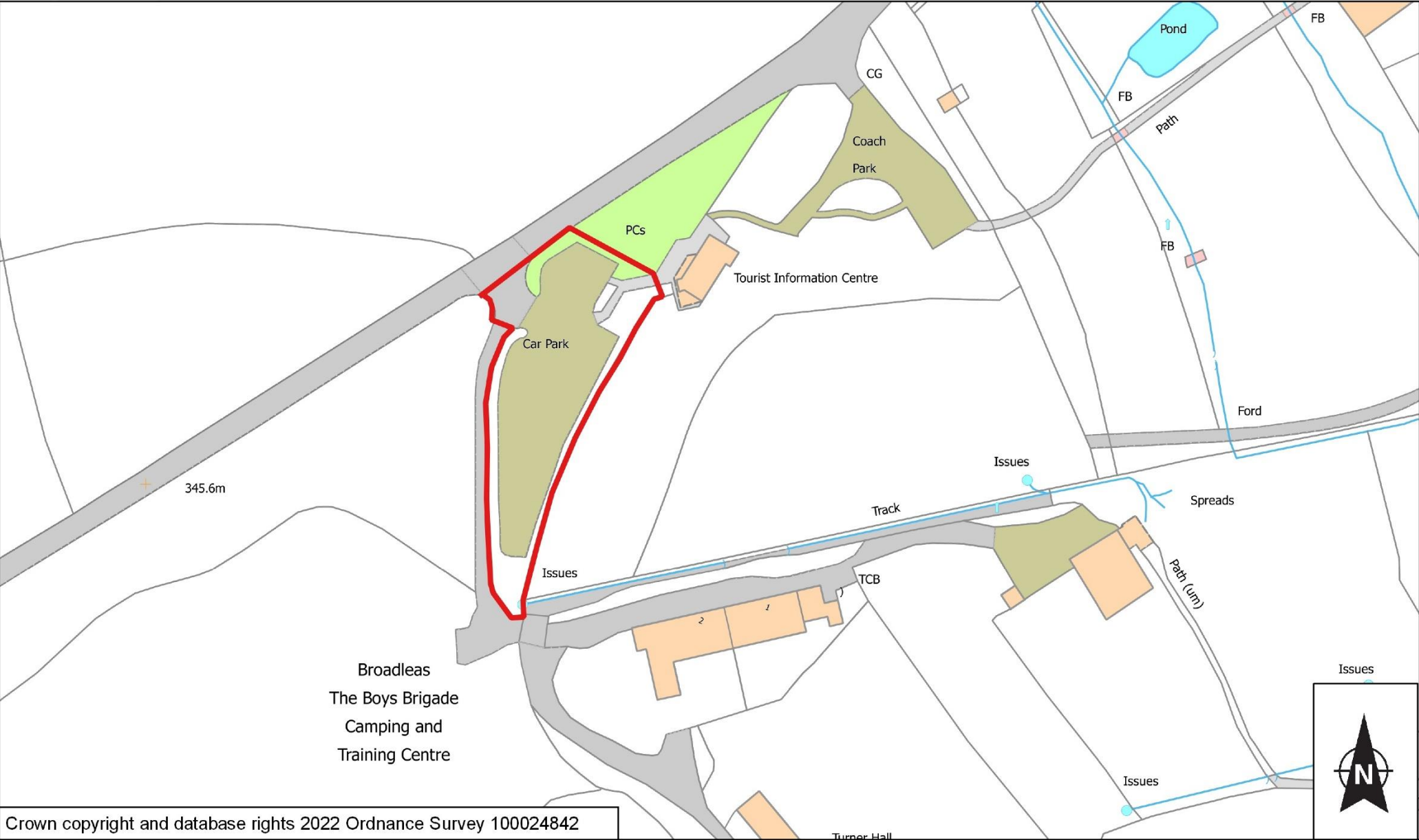

Dartmoor National Park Authority

Haytor Middle Car Park

Scale 1:1,250

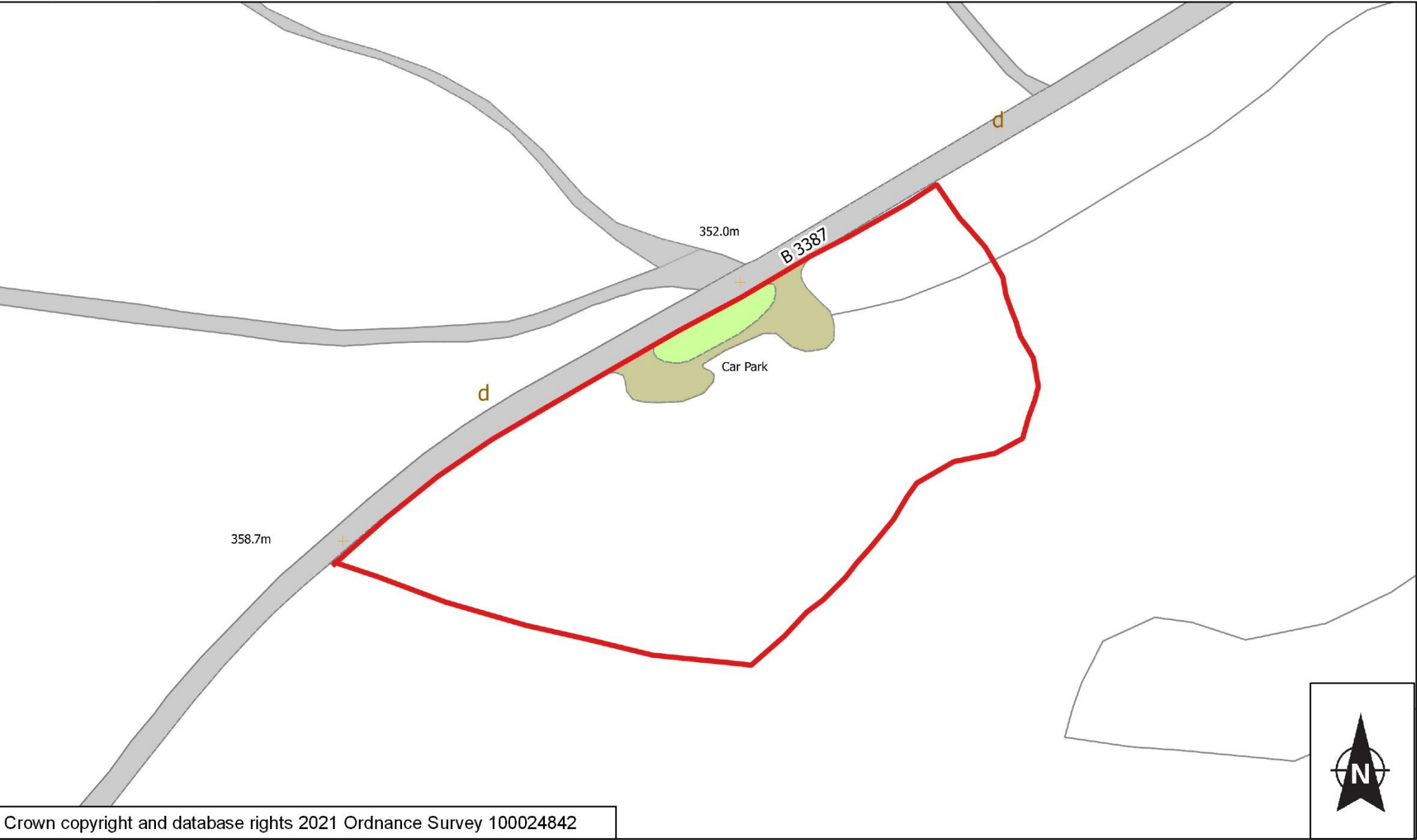

Dartmoor National Park Authority

Haytor Upper Car Park

Scale 1:623

Map created by awatson on 11/4/2022

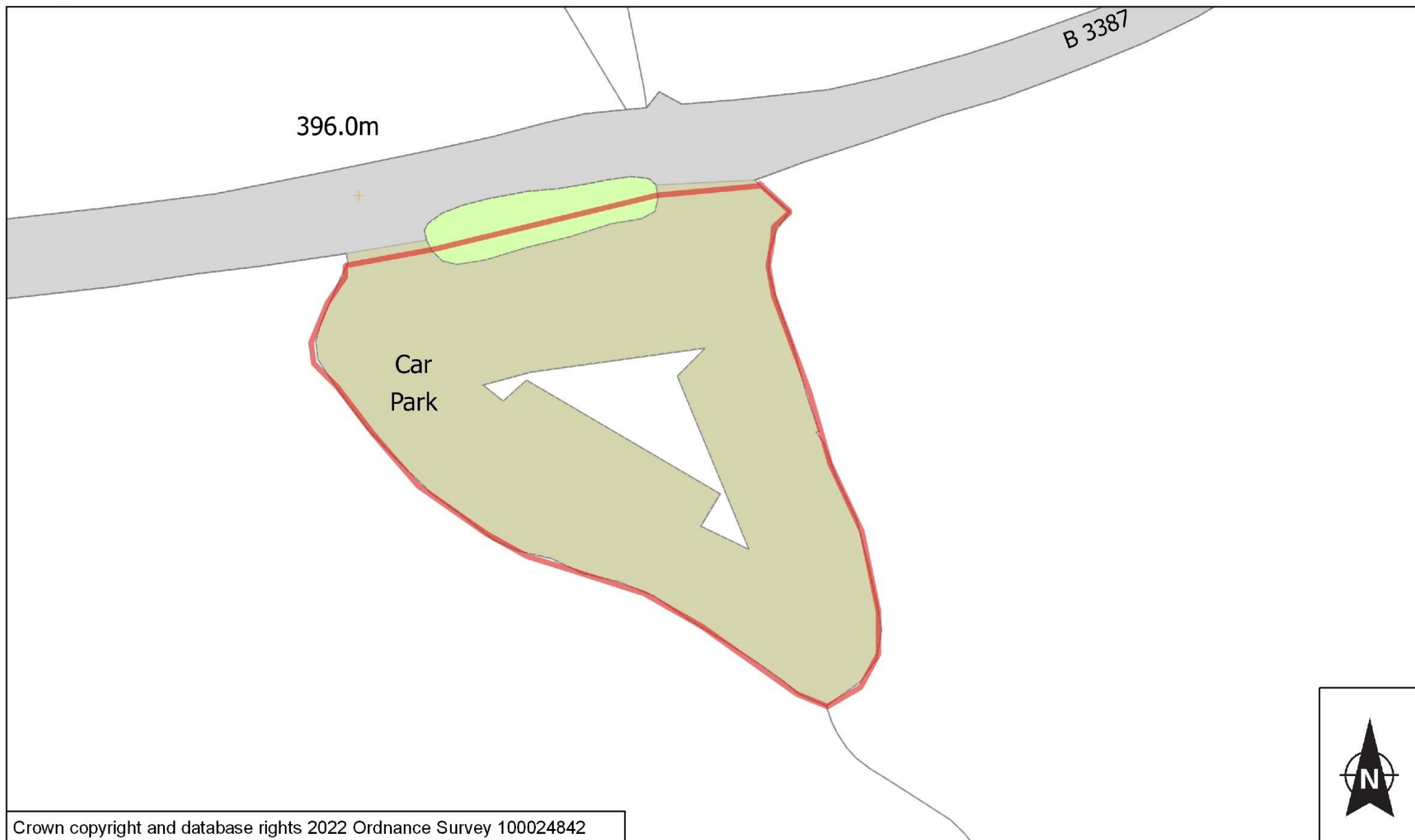



Dartmoor National Park Authority

Meldon Reservoir Car Park

Scale 1:1,250



Dartmoor National Park Authority

Postbridge Car Park

Scale 1:1,250

Map created by awatson on 11/4/2022



Dartmoor National Park Authority

Princetown Car Park

Scale 1:1,250



SCHEDULE 2
Permits

Permit Type	Valid within Parking Place	Persons eligible to apply for permit	Charge
<i>Column 1</i>	<i>Column 2</i>	<i>Column 3</i>	<i>Column 4</i>
Staff permit	<ul style="list-style-type: none"> • All Car Parks 	<ul style="list-style-type: none"> • Dartmoor National Park Authority staff 	Free
Temporary permit	<ul style="list-style-type: none"> • All Car Parks 	<ul style="list-style-type: none"> • Dartmoor National Park Authority volunteers • Contractors working on behalf of the Authority • Other persons authorised by the Authority 	Free
Vendor permit	<ul style="list-style-type: none"> • Brentor Car Park • Haytor Lower Car Park (only within the designated vendor parking space) • Haytor Upper Car Park • Meldon Reservoir Car Park 	<ul style="list-style-type: none"> • Authorised vendors 	Free *

* permit issued free of charge but there is a tender process to become an authorised vendor

dated

The COMMON SEAL of)
Devon County Council)
 was hereunto affixed)
 in the presence of)

document number _____

A Duly Authorised Officer

reference IMR/B19222

website reference 5926